

# WELD-PAK® 45i PLASMA DV

## DUAL VOLTAGE PLASMA CUTTER



Shown:  
K5420-1

### PLASMA CUTTING - ANYWHERE, ANYTIME

The Weld-Pak® 45i Plasma DV is a lightweight (25 lbs), dual-voltage plasma cutter built for versatility. It cuts up to 3/4" on 230V and 1/4" on 120V power. Designed for portability, it features a built-in toolbox for cable storage. With 45 amps of power, it easily cuts thick or expanded metal, making it ideal for farms, HVAC, autobody shops, contractors, fabricators, and homeowners. The touch-start arc ensures reliable ignition without high-frequency issues, while the Parts-in-Place™ system guarantees proper setup. Just connect compressed air, grab the torch, and start cutting.

#### Processes »

Cuts Mild Steel, Stainless, Aluminum, Expanded Metal, and other Non-Ferrous Materials

#### Output »



#### Input »

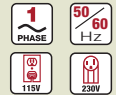

#### Product Numbers »

K5420-1

#### Cut Performance - Mild Steel»

Hand Torch

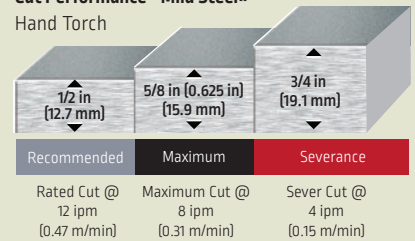

## VALUE-ADDED FEATURES

- **LED Display** – large, bright digital display of amperage setting
- **Continuous Output Control** – Focus the arc for different material thickness.
- **Touch Start System** – Reliable plasma arc initiation without high frequency.
- **Top Storage Compartment** – for convenient storage of torch, work cable, accessories, etc.
- **Lightweight and Portable** – Easily carried by one person.
- **Dual Voltage Compatible**

## KEY CONTROLS

- |                              |                               |
|------------------------------|-------------------------------|
| 1. Handle                    | 6. Plasma Torch Connection    |
| 2. Main Control Knob         | 7. On/Off Switch              |
| 3. Cut Mode Indicator LEDs   | 8. Input Cord                 |
| 4. Cut Mode Button           | 9. Cooling Fan                |
| 5. Workpiece Lead Connection | 10. Compressed Air Connection |



## TORCH DESIGN FOR OPTIMAL STARTING AND PERFORMANCE

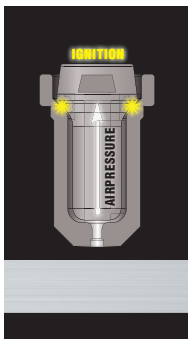

### Starting

- Air pressure pushes the electrode back
- Ignition takes place on the 'shoulder'
- No damage to the tip



- Extended consumable lifetime
- Consistent starting without High Frequency

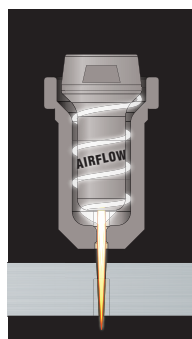

### Performance

- Enhanced swirling airflow
- Improved radius and electrode/nozzle design



- More concentrated arc
- Faster cutting speeds
- Greater thickness cutting capacity

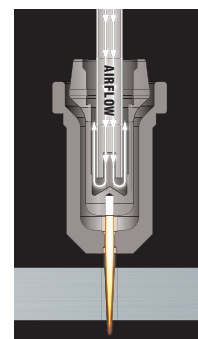

### Consumable Life

- Internal airflow keeps the electrode and tip cool



- Increases life of consumable components
- Lower operating costs

## 45i REPLACEMENT TORCH CONSUMABLES

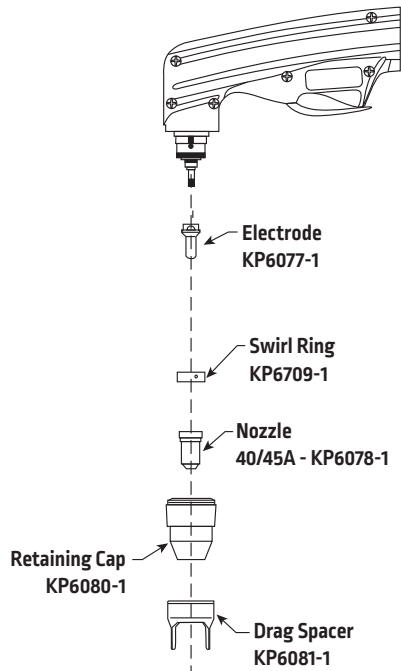

- It is normal for the electrode and nozzle to wear during operation.
- Electrodes should typically be replaced when erosion reaches 0.025 in. (0.65 mm).
- A green and erratic arc will indicate the end of electrode life. The electrode should be immediately replaced.
- It is recommended that the KP2843-1 Electrode and KP2843-2 Nozzle (40/45A) be replaced as a complete set.

## WHAT'S INCLUDED

	Base Unit (K5420-1)
Plasma torch 13 ft. (4 m) cable	•
Internal water separator	•
Work clamp and cable	•
Spare consumables	•
Shoulder strap	•
Input power cord	•
Dual voltage adapter	•



## RECOMMENDED ACCESSORIES



### Welding Cart

Offers lightweight transport for welders, plasma cutters and welding accessories. An angled top shelf offers access to controls and a lower tray for added storage capacity. Full-featured cart is also designed to store and transport a 80 cu. ft. gas cylinder and welding cables.  
Order K2275-3

## RECOMMENDED ENGINE DRIVES <sup>(1)</sup>



Ranger® 330MPX™



Ranger® 330MPX™ EFI



Ranger® AIR 260 MPX™



Vantage® 322



Vantage® 549X



Vantage® 566X



Frontier® 400X



Maverick® 325X

<sup>(1)</sup> When run in the high idle mode.

The Weld-Pak™ 45i can be operated on engine driven generators as long as the 230 volt auxiliary meets the following conditions.

- The AC Waveform peak voltage is below 400 volts.
- The AC waveform frequency is between 55 and 65 Hz.
- The RMS voltage of the AC waveform is always greater than 208VAC.

## PRODUCT SPECIFICATIONS

Product Name	Product Number	Input Power Voltage/Phase/Hertz	Rated Output Current/Voltage/Duty Cycle	Recommended Circuit Breaker	Output Range	Gas Pressure Required	Gas Flow Rate	Dimensions H x W x D in (mm)	Net Weight lb (kg)
45i PLASMA DV	K5420-1	230/120/1/50/60	<b>230 V</b> 32A / 92.8V / 100% 41A / 96.4V / 60% 45A / 98V / 50%  <b>120 V</b> 32A / 92.8V / 100% 15A / 86V / 100% 16A / 86.4V / 60% 20A / 88V / 20%	230 V - 30 A 120 V - 20 A	15-45A	80 to 130 psi (6-9 bar)	70psi @ 125-200SCFH (5 Bar @ 80 Liters/min)	13.7 (349) 8.5 (216) 17 (432)	25.9 (11.8)

For best cutting results with Lincoln Electric® equipment, always use Lincoln Electric consumables. Visit [www.lincolnelectric.com](http://www.lincolnelectric.com) for more details.

### CUSTOMER ASSISTANCE POLICY

The business of Lincoln Electric is manufacturing and selling high quality welding equipment, automated welding systems, consumables, and cutting equipment. Our challenge is to meet the needs of our customers, who are experts in their fields, and to exceed their expectations. On occasion, purchasers may ask Lincoln Electric for information or technical information about their use of our products. Our employees respond to inquiries to the best of their ability based on information and specifications provided to them by the customers and the knowledge they may have concerning the application. Our employees, however, are not in a position to verify the information provided or to evaluate the engineering requirements for the particular weldment, or to provide engineering advice in relation to a specific situation. Accordingly, Lincoln Electric does not warrant or guarantee or assume any liability with respect to such information or communications. Moreover, the provision of such information or technical information does not create, expand, or alter any warranty on our products. Any express or implied warranty that might arise from the information or technical information, including any implied warranty of merchantability or any warranty of fitness for any customers' particular purpose or any other equivalent or similar warranty is specifically disclaimed. Lincoln Electric is a responsive manufacturer, but the definition of specifications, and the selection and use of specific products sold by Lincoln Electric is solely within the control of, and remains the sole responsibility of the customer. Many variables beyond the control of Lincoln Electric affect the results obtained in applying these types of fabrication methods and service requirements.

**The Lincoln Electric Company**  
 22801 St. Clair Avenue · Cleveland, OH · 44117 · U.S.A.  
[www.lincolnelectric.com](http://www.lincolnelectric.com)